



## **GREAT TATTENHAMS**

EPSOM DOWNS

[www.michael-everett.co.uk](http://www.michael-everett.co.uk)



# 189 GREAT TATTENHAMS

EPSOM DOWNS, KT18 5RA

A well presented ground floor maisonette offered for sale with no onward chain. The neutrally decorated accommodation comprises of entrance porch leading to a generous entrance hallway with double storage cupboard and doors to all rooms. There is a lovely sized living/dining room, modern fitted kitchen with an array of fitted units and door leading to your very own private garden which has an awn and patio area. There are two double bedrooms, a separate wc and bathroom. This property is further enhanced with double glazing, gas central heating, a long lease, one of 4 properties in a small block located within walking distance of local shops/amenities for your everyday needs and Tattenham Corner station with links into London Bridge and Victoria stations. There is a garage to the rear which can be accessed via a gate from your garden and access road to the side.

ASKING PRICE: **£395,000**

824.41FT 76.59M2

EPC RATING: C COUNCIL TAX BAND: D

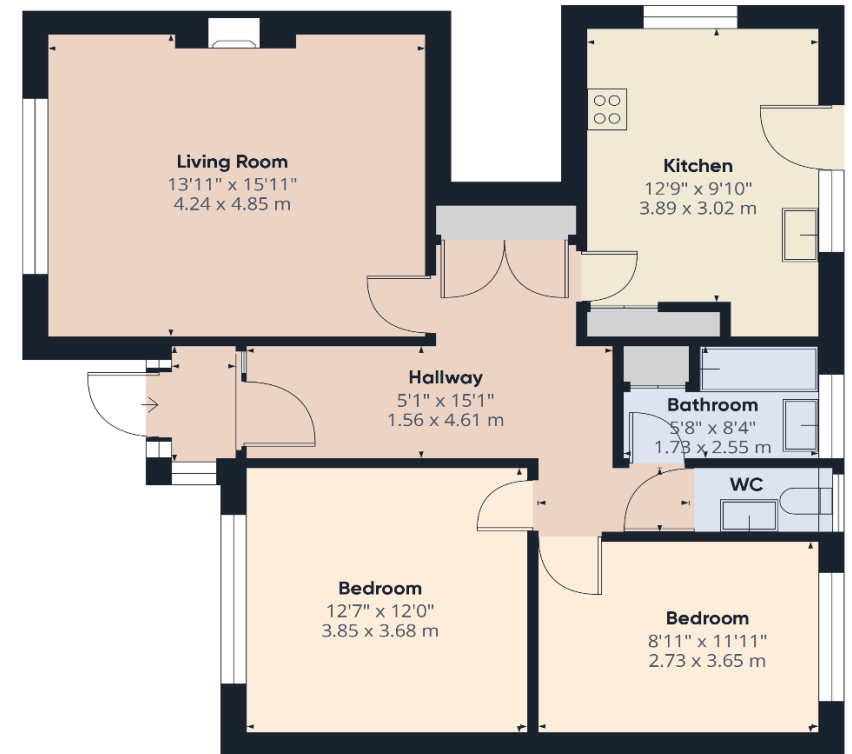

**WALTON ON THE HILL** 61 Walton Street, Walton-on-the-Hill, Surrey KT20 7RZ  
**01737 814877**